

Packster 80 STEEL STEERING LINKAGE KIT (VBK0198)

The steel steering linkage kit fits to Packster 80 with front fork Spinner Grind OS. In combination with the dampening headset of Cane creek your Packster 80 will get a more stable handling.

Scope of delivery

- 1x headset Cane Creek Visco Set incl. installation guide
- 1x steel steering linkage Packster 80 incl. silicon tube (already assembled)
- 1x hinge block incl. ball bearing
- 2x linkage ends, already mounted
- 1x steering lever and clamp for Spinner OS
- 1x swivel head GARSW 8
- 1x bearing cover Load G2
- 3x bolt M8x30 ISO 7380-1 A2 with splint hole
- 2x bolt M5x20 DIN 912 A2
- 2x bolt M5x25 DIN 912 A2
- 3x splint 2,5x12mm EN ISO 1234
- 1x nut M8 DIN 934-8 A2
- 2x washer M8 DIN 125 A2
- 1x O-Ring 6x3,5
- 1x O-Ring 12x2,5

Dismantle existing steering linkage and headset

1. Remove splints ① and bolts ② and ③ at front and rear linkage end (see fig. 1 and 2). Remove steering linkage.



fig.1: front linkage end



fig.2: rear linkage end

2. Dismantle front fork and existing headset (incl. cups and crown race).
3. Install new Cane Creek headset according to separate enclosed installation guide.
4. Install front fork again.

Stand: 12.04.2019 15:38:00

Mount new steering linkage

1. Mount steering lever ① with bolts M5x20 ② and M5x25 ③ at right stancion. Do not tighten bolts.
2. Push steering lever to the top and adjust it according fig. 3. Tighten bolts ③ first and then bolts ② (not visible in fig. 3). **Tightening torque: 5Nm.**
3. Turn swivel head ④ with nut ⑤ into front end ⑩ (see fig. 4). Do not tighten nut yet. Insert bolt ⑦ through swivel head and O-Ring ⑧, apply threadlock adhesive and turn bolt into steering lever. **Tightening torque: 5Nm.**
4. Install splint ⑨.

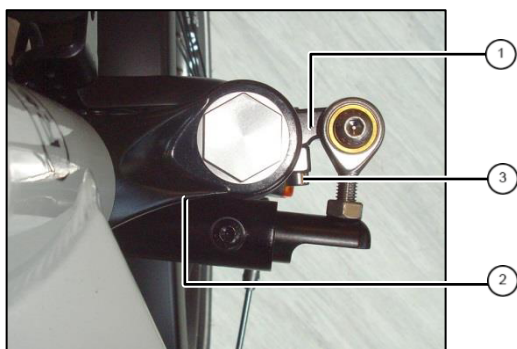

fig. 3: steering lever at front fork

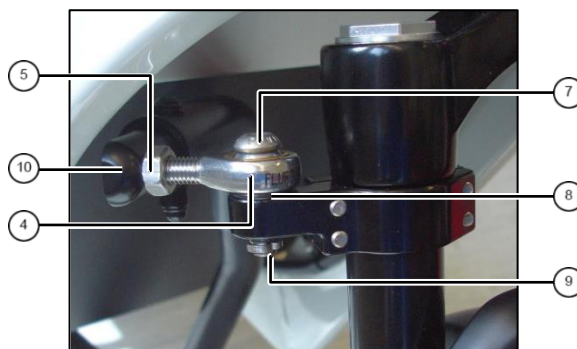

fig. 4: front linkage end

5. Install hinge block ⑩ with bolt ⑦ and threadlock adhesive, bearing cover ⑪ and washer ⑫ at steerer arm ⑬ (see fig. 5). **Tightening torque 8Nm.**
6. Stick O-Ring ⑭ on bolt and install splint ⑨ (see fig. 5).
7. Stick bolt ⑦ with washer ⑫ through hinge block. Apply threadlock adhesive and turn bolt into rear linkage end ⑩ (see fig. 6). **Tightening torque 8Nm.**
8. Install splint ⑩.

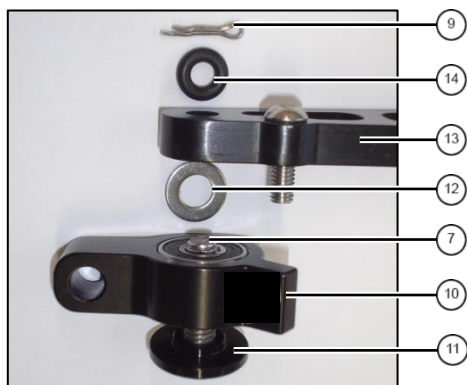

fig. 5: hinge block

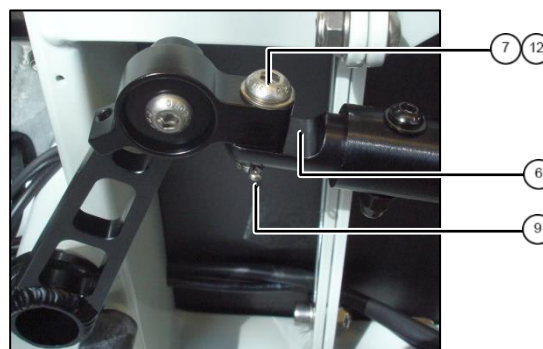

fig. 6: rear linkage end

Datei: VBK0198-P80-Lenkgestänge-Stahl-170925.docx

Adjust steering linkage

1. Turn handlebar to the right. Steering linkage may touch wooden plate with its silicon tube.
2. Turn handlebar to the left. Steering linkage may touch right stancion with its silicon tube.
If this is not the case, open bolts M5x20 ⁽²⁾ and adjust steering lever ⁽¹⁾. Retighten bolts M5x20.

Tightening torque: 5Nm.

3. Adjust swivel head ⁽⁴⁾ parallel to steering lever ⁽⁵⁾. If necessary, loosen bolt ⁽¹⁰⁾ and twist front end towards steering linkage. Retighten bolt ⁽¹⁰⁾. **Tightening torque: 5Nm.**
4. Hold swivel head with wrench SW10 and tighten nut ⁽⁷⁾ at the same time.

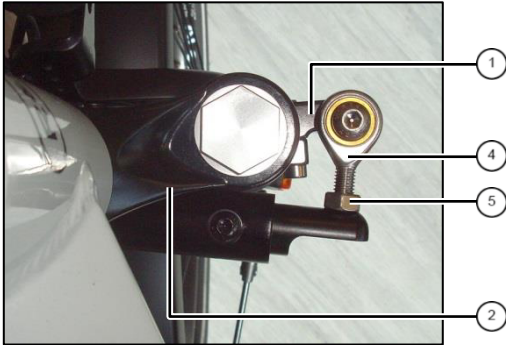

fig. 7: front linkage end

Adjust handlebar stem

1. Check position of handlebar: handlebar shall be rectangular to front wheel.
2. Loosen bolts to adjust handlebar stem. Retighten bolts. **Tightening torque: 8Nm.**